



# HAFEZ PANJU

PERSONAL REAL ESTATE CORPORATION

TRUST THE VALUE

1007 - 4425 HALIFAX ST  
BURNABY

Hafez Punju

604 377 3689

[www.hafezrealty.com](http://www.hafezrealty.com)

[hafez@hafezrealty.com](mailto:hafez@hafezrealty.com)

MAIN LEVEL: 1,108 sq ft

TOTAL: 1,108 sq ft

BALCONY: 132 sq ft

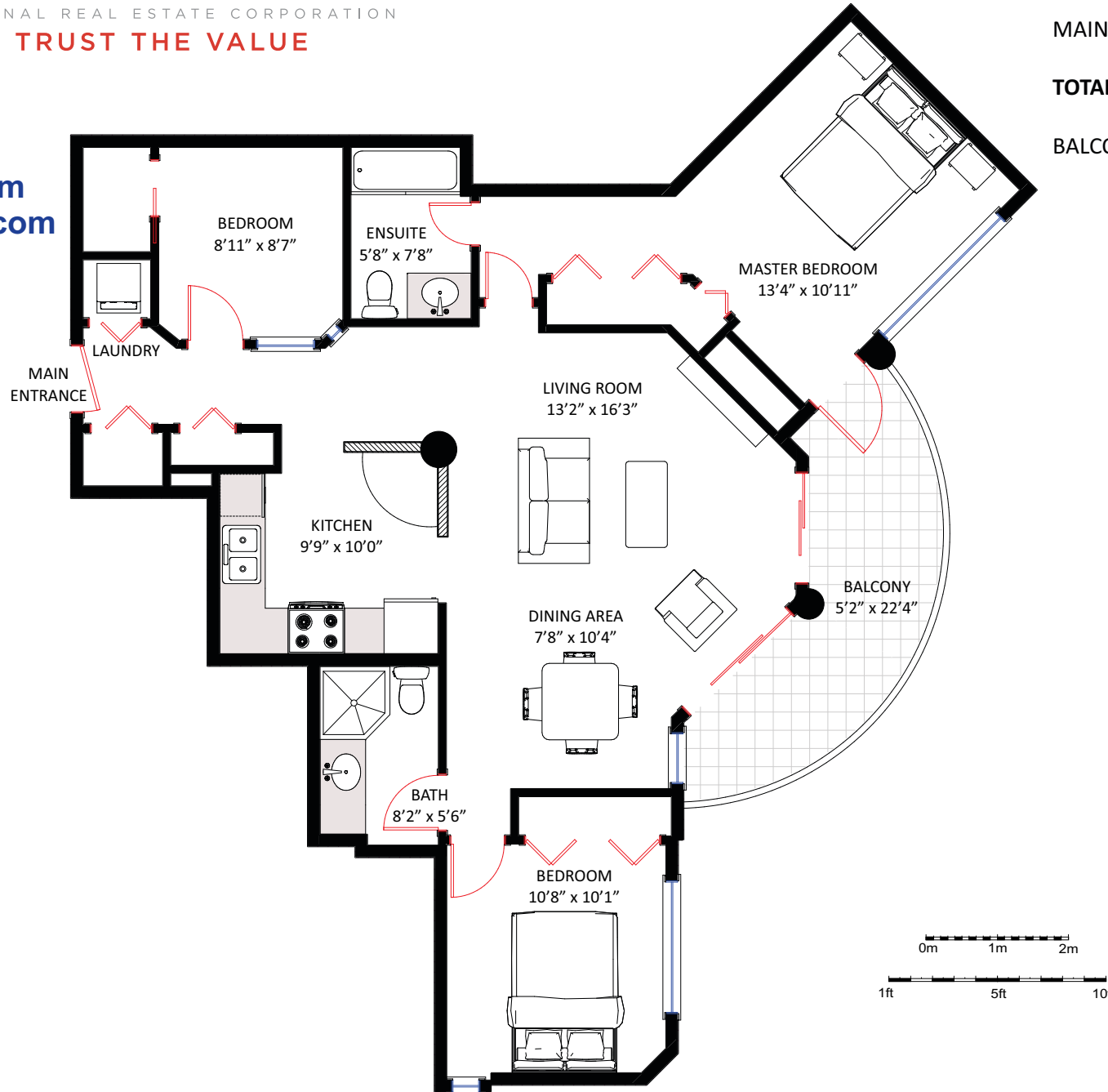

The information in these floor plans is believed to be accurate, but not guaranteed. \* Estimate only.

MATTERPORT 3D SCANNING - PHOTOGRAPHY - FLOOR PLANS - REAL VISION TOURS - VIDEO PRODUCTION - WEBSITES - VIRTUAL REALITY

